

NOTE:-
 TERMINAL BOX CAN BE MOUNTED
 (TOP OR LEFT) BY REFITTING FEET AND
 LIFTING LUGS 90° IN APPROPRIATE
 DIRECTIONS. CABLE ENTRY CAN BE
 SUPPLIED IN ANY ONE OF FOUR POSITIONS
 AT 90° INTERVALS

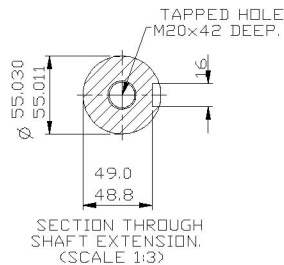

CUSTOMER		
ORDER No.		
SERIAL No.		
FRAME SIZE		
Kw	R.P.M.	
Hz	PHASE 3	
VOLTS	POLES	
BRGS.	D.E	N.D.E
MOTOR NETT. WT.		Kg.
INSULATION CLASS		
TEMPERATURE RISE °C		
DESIGN AMBIENT TEMPERATURE °C		
HEATER WATTS & VOLTS (IF FITTED)		
- WATTS, - VOLTS		

REMARKS

ALL DIMENSIONS IN MILLIMETRES

FIRST ANGLE PROJECTION

BROOK CROMPTON

NOTE:
 2.5 ENDPLAY WILL BE PROVIDED FOR ENDTHRUST PROTECTION WHEN CUSTOMERS NOTIFY US OF THEIR INTENTION TO USE RIGID COUPLINGS AND DRIVEN MACHINES WITHOUT ENDPLAY.

OUTLINE DIMENSIONS OF STANDARD FOOT MOUNTED METRIC A.C. MOTOR TOTALLY ENCLOSED FAN VENTILATED. TERMINAL BOX MOUNTED ON RIGHT HAND SIDE VIEWED ON DRIVE END. FRAME SIZE: W-DF200LX (ALL POLES).

SCALE	1:6	DATE
DRAWN		
CHECKED		
APPROVED		

DRG. No.		
REVISION:		DATE