

NOTE:-  
 TERMINAL BOX CAN BE MOUNTED  
 (LEFT OR RIGHT) BY REFITTING FEET AND  
 LIFTING LUGS 90° IN APPROPRIATE  
 DIRECTIONS. CABLE ENTRY CAN BE  
 SUPPLIED IN ANY ONE OF FOUR POSITIONS  
 AT 90° INTERVALS

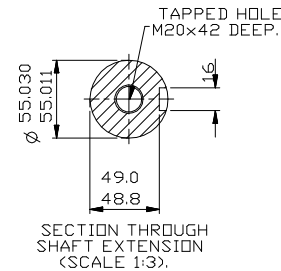

CUSTOMER	
ORDER No.	
SERIAL No.	
FRAME SIZE	
KW	R.P.M.
Hz	PHASE 3
VOLTS	POLES
BRGS.	D.E. N.D.E
MOTOR NETT. WT.	Kg.
INSULATION CLASS	
TEMPERATURE RISE °C	
DESIGN AMBIENT TEMPERATURE °C	
HEATER WATTS & VOLTS (IF FITTED)	
- WATTS, - VOLTS	

REMARKS

**BROOK CROMPTON**  
 PRELIMINARY

Large Industrial Motors  
 Guiseley, LEEDS LS20 9NZ

ALL DIMENSIONS IN MILLIMETRES

FIRST ANGLE PROJECTION

**BROOK CROMPTON**

Large Industrial Motors  
 GUISELEY, LEEDS, LS20 9NZ.

NOTE!  
 2.5 ENDPLAY WILL BE PROVIDED FOR ENDTHRUST PROTECTION WHEN CUSTOMERS NOTIFY US OF THEIR INTENTION TO USE RIGID COUPLINGS AND DRIVEN MACHINES WITHOUT ENDPLAY.

OUTLINE DIMENSIONS OF STANDARD FOOT MOUNTED METRIC A.C.  
 TOTALLY ENCLOSED FAN VENTILATED.  
 FRAME SIZE: W-DF200LX (ALL POLES).

SCALE	1:6	DATE
DRAWN	APT	11.3.99
CHECKED	APT	11.3.99
APPROVED	IJW	11.3.99

DRG. No.	M21600		
REVISION:	A M.E	DATE	24.6.99